

# 12 Bellefair Ave, Toronto, ON

Main Building: Total Exterior Area Above Grade 1684 sq ft

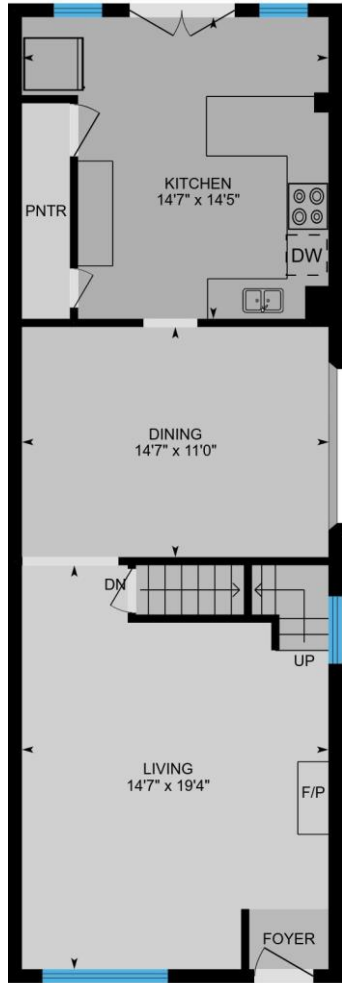

**1st Floor**  
Exterior Area 746 sq ft

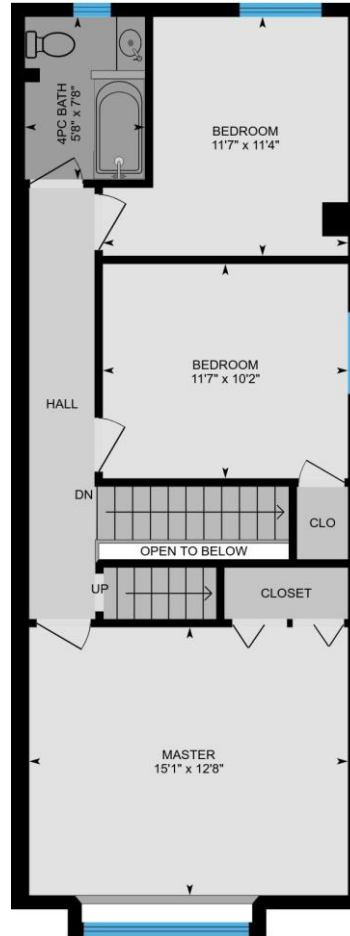

**2nd Floor**  
Exterior Area 699 sq ft

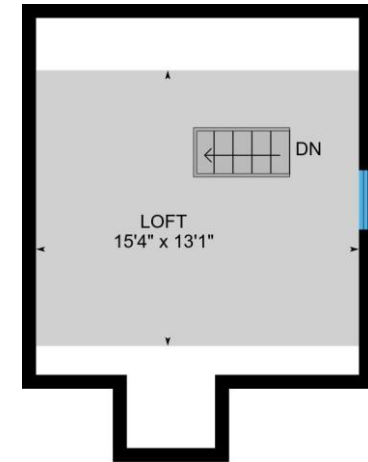

**3rd Floor**  
Exterior Area 240 sq ft

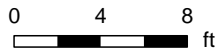

White regions are excluded from total floor area. All room dimensions and floor areas must be considered approximate and are subject to independent verification. For method of measurement please see <https://youriguide.com/measure/>.

PREPARED: Sep, 2018



# 12 Bellefair Ave, Toronto, ON

## Main Building

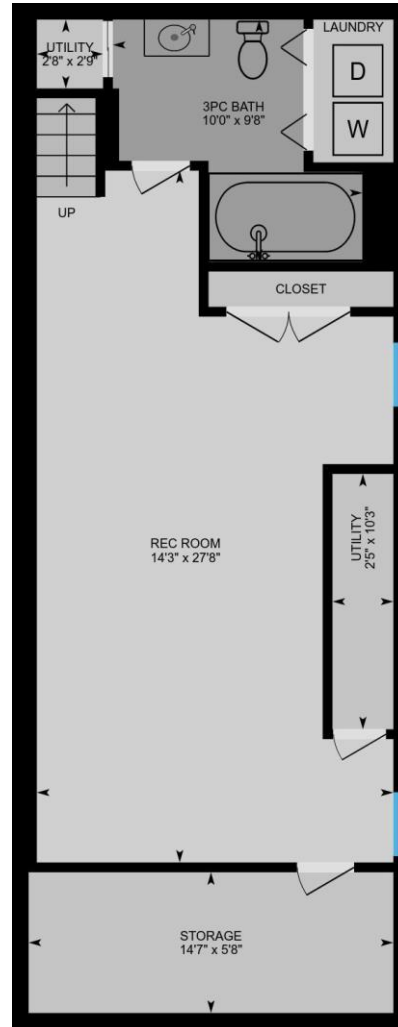

**Basement (Below Grade)**  
Exterior Area 642 sq ft

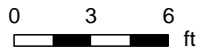

PREPARED: Sep, 2018

# 12 Bellefair Ave, Toronto, ON

1st Floor Total Exterior Area 746 sq ft

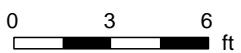
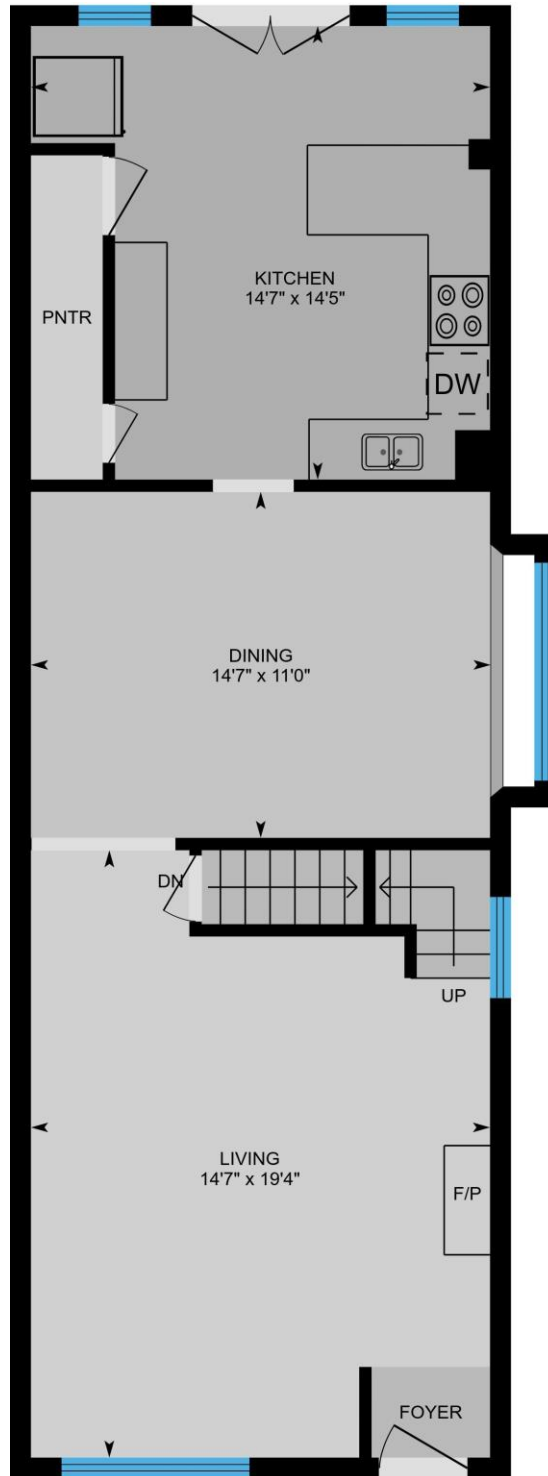

PREPARED: Sep, 2018



N

# 12 Bellefair Ave, Toronto, ON

2nd Floor Total Exterior Area 699 sq ft

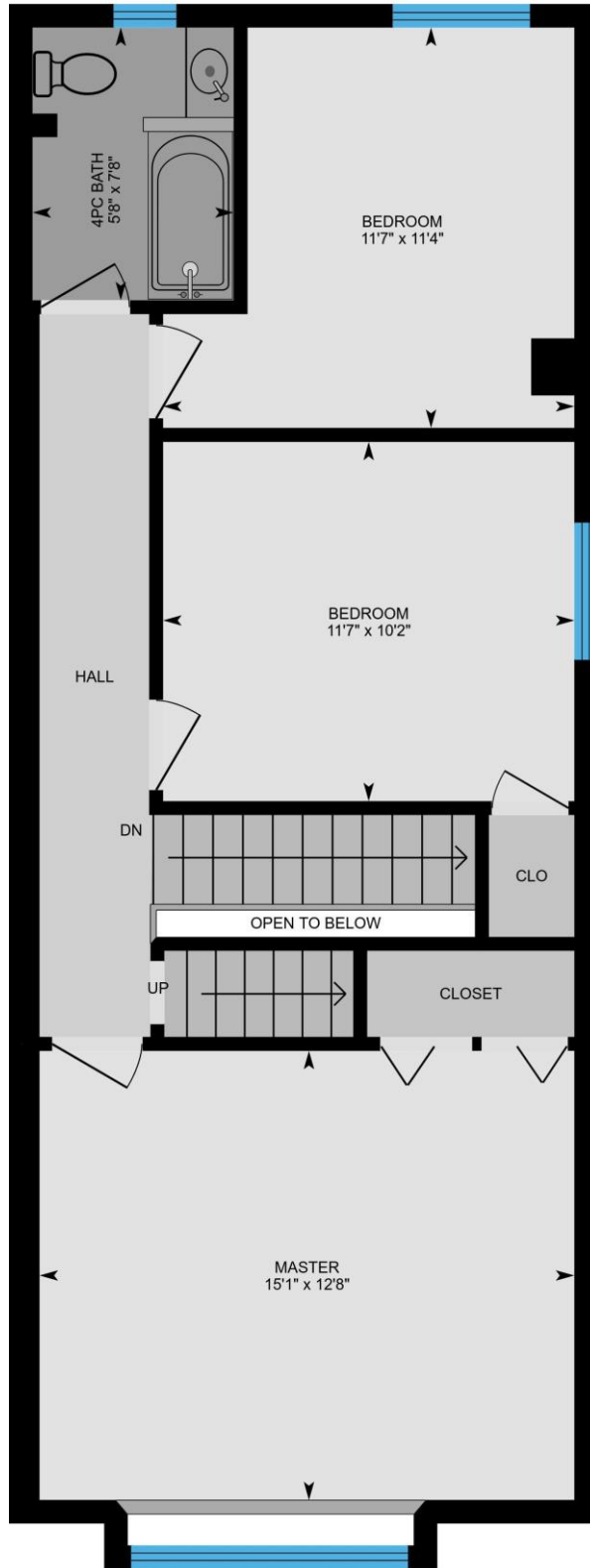

N

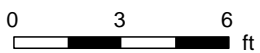

PREPARED: Sep, 2018

# 12 Bellefair Ave, Toronto, ON

3rd Floor Total Exterior Area 240 sq ft

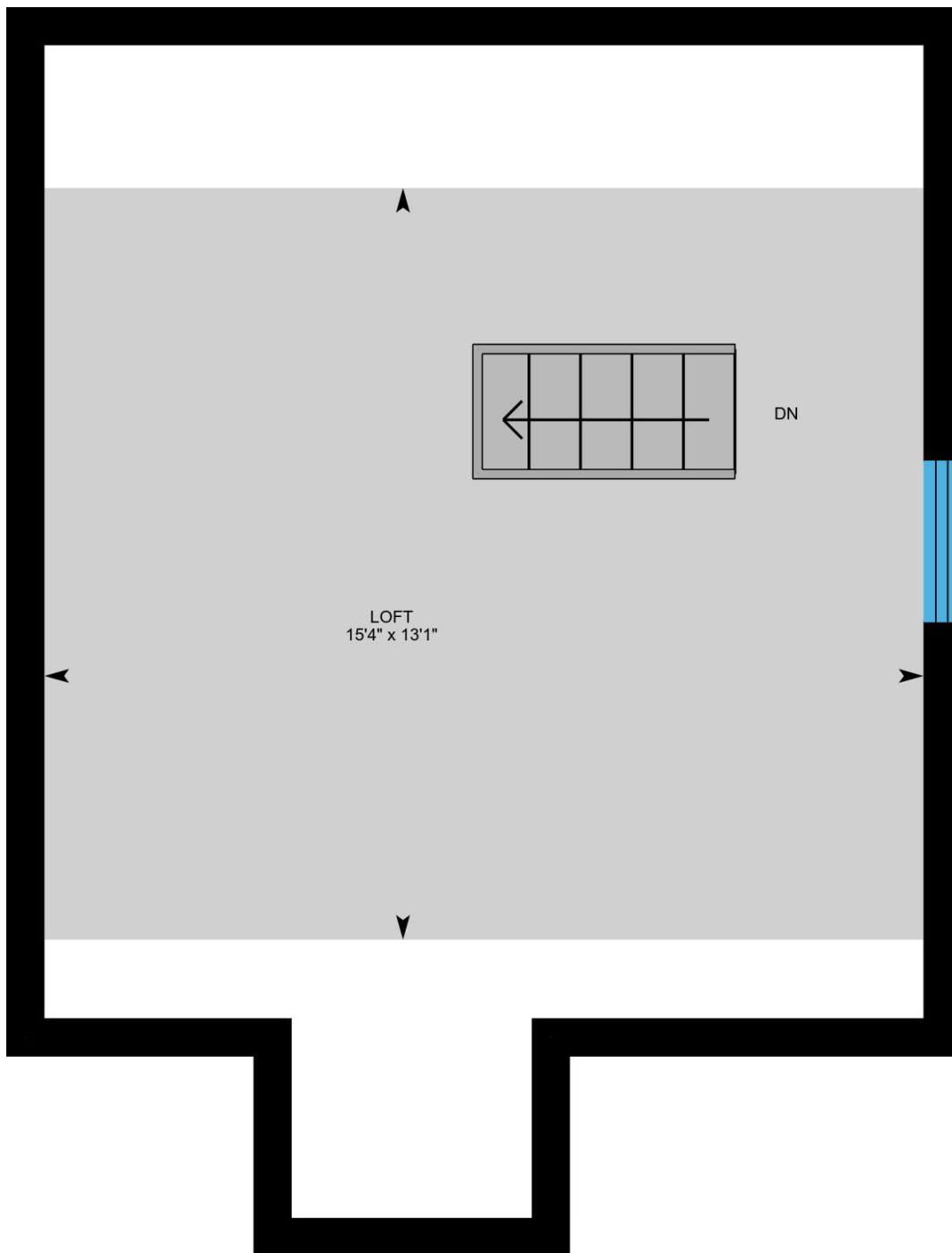

z



PREPARED: Sep, 2018

White regions are excluded from total floor area. All room dimensions and and floor areas must be considered approximate and are subject to independent verification. For method of measurement please see <https://youriguide.com/measure/>.

# 12 Bellefair Ave, Toronto, ON

Basement Total Exterior Area 642 sq ft

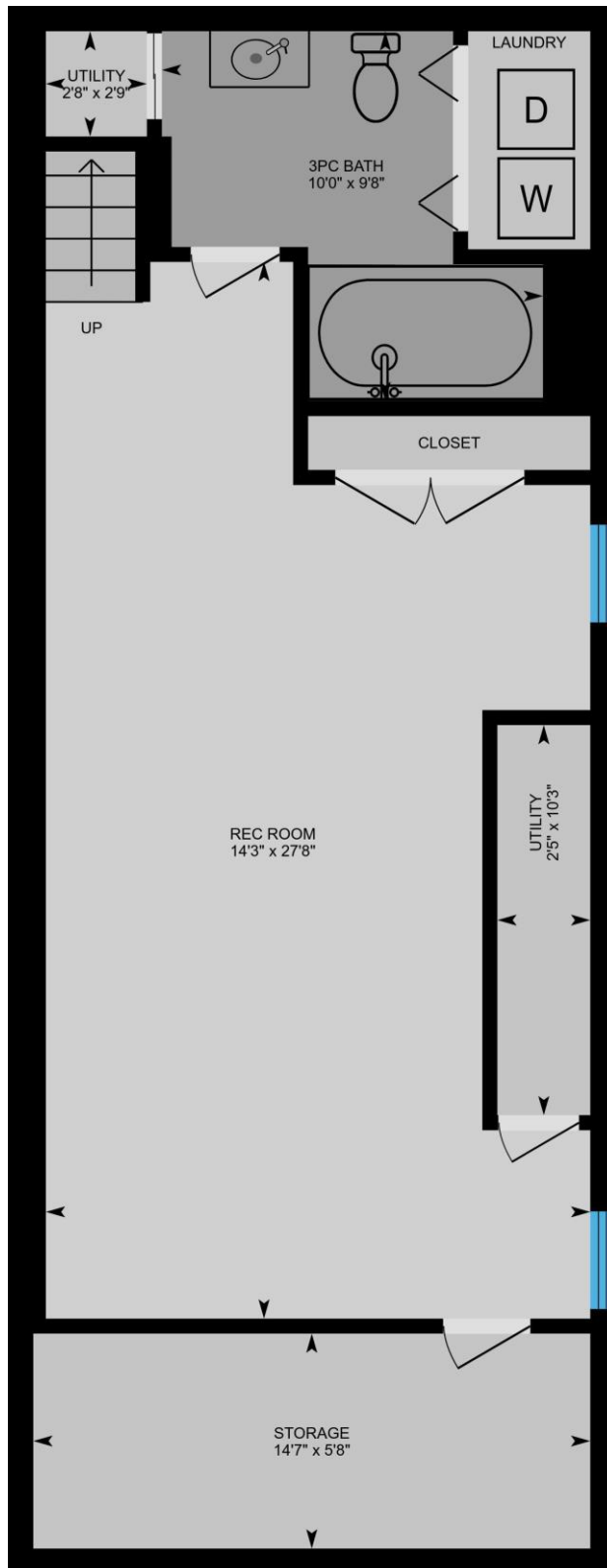

N



PREPARED: Sep, 2018

White regions are excluded from total floor area. All room dimensions and and floor areas must be considered approximate and are subject to independent verification. For method of measurement please see <https://youriguide.com/measure/>.

# 12 Bellefair Ave, Toronto, ON

## Property Details

### Room Measurements

Only major rooms are listed. Some listed rooms may be excluded from total interior floor area (e.g. garage). Room dimensions are largest length and width; parts of room may be smaller. Room area is not always equal to product of length and width.

### Main Building

#### 1ST FLOOR

Dining: 14'7" x 11'0"

Living: 14'7" x 19'4"

Kitchen: 14'7" x 14'5"

#### 2ND FLOOR

Master: 15'1" x 12'8"

Bedroom: 11'7" x 10'2"

Bedroom: 11'7" x 11'4"

4pc Bath: 5'8" x 7'8"

#### 3RD FLOOR

Loft: 15'4" x 13'1"

#### BASEMENT

Utility: 2'8" x 2'9"

Storage: 14'7" x 5'8"

Rec Room: 14'3" x 27'8"

3pc Bath: 10'0" x 9'8"

Utility: 2'5" x 10'3"

### Floor Area Information

For explanation of floor area calculations and method of measurement please see <http://youriguide.com/measure/>

### Main Building

Building Perimeter Wall Thickness: 8 in

#### 1ST FLOOR

Interior Area: 664 sq ft

Perimeter Wall Length: 123 ft

Exterior Area: 746 sq ft

#### 2ND FLOOR

Interior Area: 621 sq ft

Perimeter Wall Length: 116 ft

Exterior Area: 699 sq ft

#### 3RD FLOOR

Interior Area: 201 sq ft

Perimeter Wall Length: 58 ft

Exterior Area: 240 sq ft

#### BASEMENT (Below Grade)

Interior Area: 568 sq ft

Perimeter Wall Length: 111 ft

Exterior Area: 642 sq ft

### Total Above Grade Floor Area

**Main Building Exterior: 1684 sq ft**

Prepared: Sep 22, 2018

Take full control of your iGuide and sign up to the Portal ([manage.youriguide.com](http://manage.youriguide.com)) to add property details, customize photo galleries, rename rooms and much more! Sign up today or contact us for further details.

Please check your MLS policy for using branded vs. unbranded virtual tours.